

# Sciener®



Find more information and help for your product at the following  
Official website: <http://www.sciener.co>

Please read this manual carefully before installation

- Please contact us at +6016-8220059 for assistance with installation, commissioning, etc. that have not been listed in the user's installation manual.
- The performance of this product is under continuous improvement, subject to change without notice.

Anti-theft door lock



Model	M101
Dimensions	W76mm x H310mm x T30mm
Material	Shell stainless steel / lock body iron
Weight	2.4KG (with lock body)
Communication Methods	Bluetooth 4.0ble
Supporting systems	Android 4.3 / iOS 7.0 above
Stand-by current	≈20μA
Operating current	≈200 mA
Power supply	4 AA Alkaline 1.5V Batteries (LR6) (6V)
Unlock time	≈1.5 second

Product Installation and Parts List

- **Note:** The door lock frame is greater than 110mm, and the door thickness can be installed in the range of 35mm ~ 50mm.

Package list:

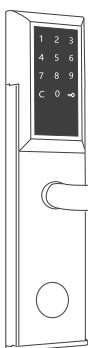

Front panel

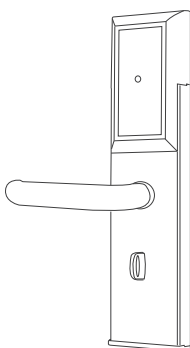

Back panel



Front & Back  
rubber gasket

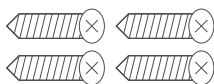

Wood screws x 5

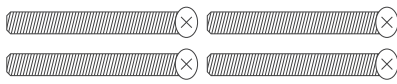

55mm lock screw x 4



Strike plate

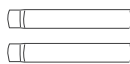

40mm screw sleeve

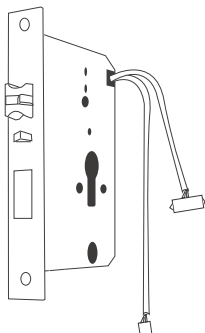

Standard electronic lock body



thumbturn spindle

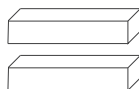

Spindle x 2

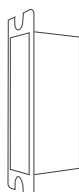

Strike box



Lock body x 1



Key x 2

## Precautions before installing and adjusting the door lock

- Before installing the lock, please check that all the accessories are present. If your door needs to drill holes across, please seek professional help in order to avoid unnecessary property damage.

Before installation, connect the front panel of the lock to the back panel, bind the lock with the app, and then install the lock to the door after setting up.

## Set up the lock function before installing

### ■ How to connect front and back panels

Remove the front panel power cord ①. Plug in figure ② position. Connect the figure ③ lock body connector to the battery case for testing.

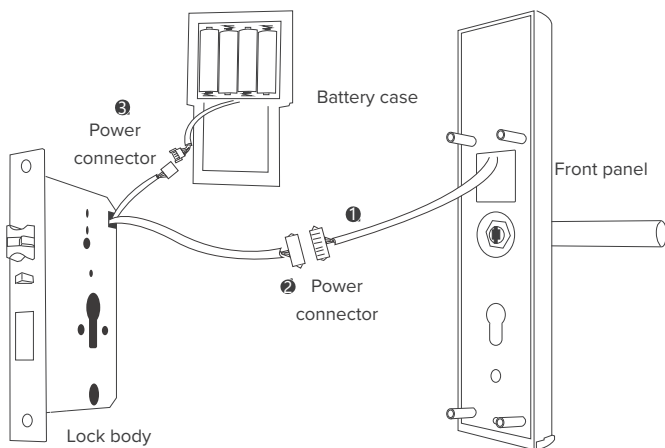

## Add & delete password or Bluetooth administrator

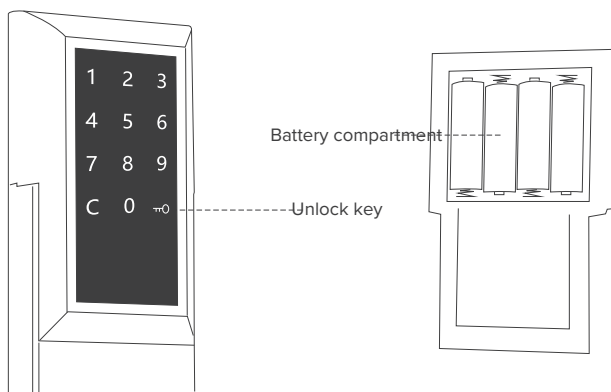

### ⚠ Important Note

#### ■ Pair with app using bluetooth

After power is on, while the front panel touchscreen backlight is off:

1. Tap the touch screen to active
2. Open the app
3. Tap "profile picture"- "+add lock" on the top left corner, select door lock.
4. Select the lock device name that is found. After adding successfully, the page will jump to the lock list;

If not successful, repeat the above steps or long press the back panel adapter and try again.

## Install lock body and lock cylinder

- If your door lock and panel mounting holes do not match with our products. You need to ask for the professionals to refer to our products.
- For attachments in the [drilling] hole, non-professionals should not arbitrarily open holes to avoid causing property damage!

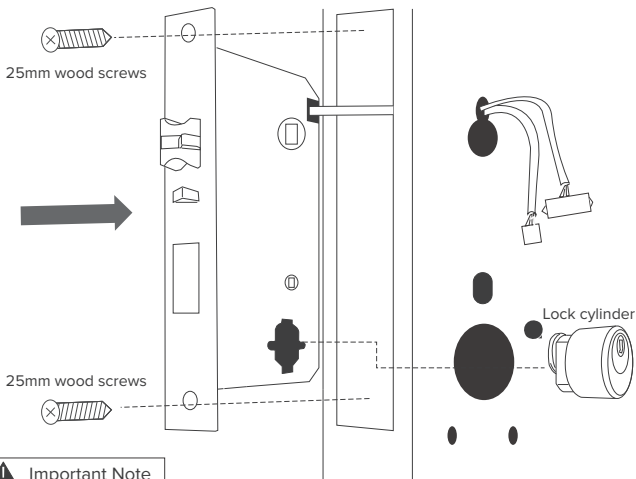

### ■ Cylinder ① position installation instructions

Restore lock tongue in place. Put the cylinder tongue through the door hole into the lock body. If you encountered blocking, please shake the lock and try again.

## Install the front & back panel

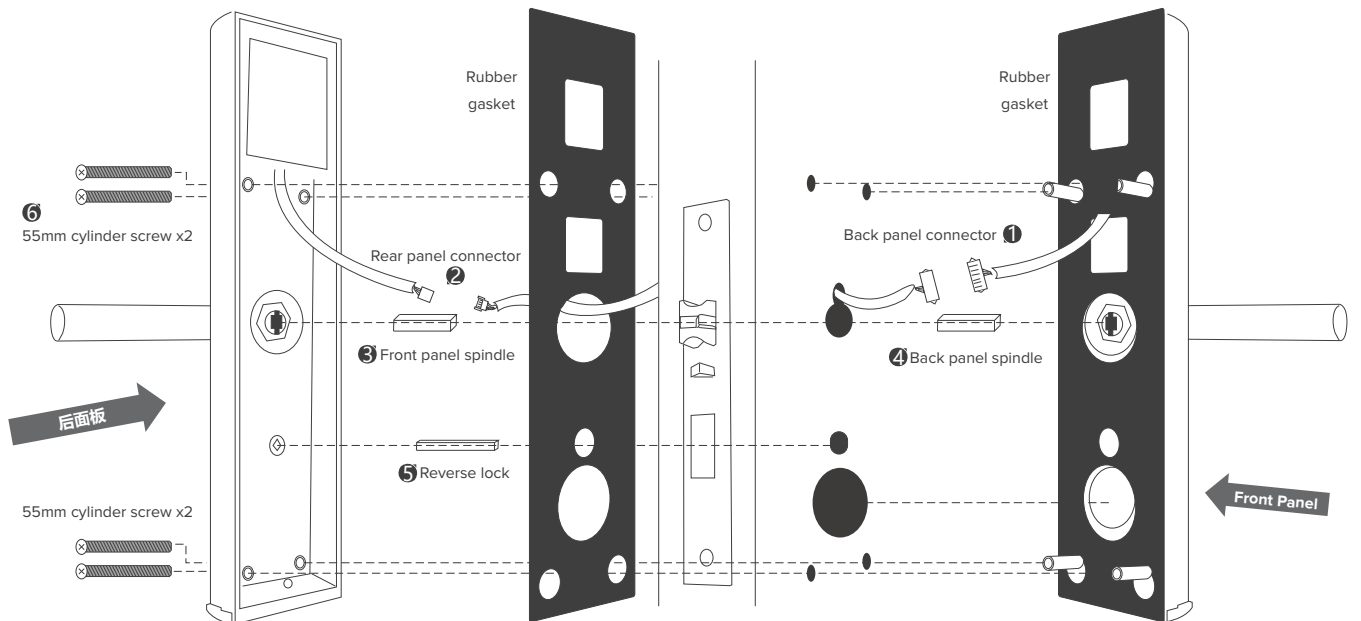

### ■ Installation instructions

**Front panel :** After installing the lock body, connect the two connecting wires of the lock body. Connect the large plug the door to connect the front panel. Then connect the small plug to the rear panel as shown in Figure ① ②. Insert the square bar into the handle hole of the front panel and pad the rubber pad.

**Back panel :** Connect the lock connector. Insert the square bar of the rear panel of figure ③. Insert reverse locking square bar of figure ⑤ and pad the rubber pad. Screw in four 55mm screws. The installation is complete.

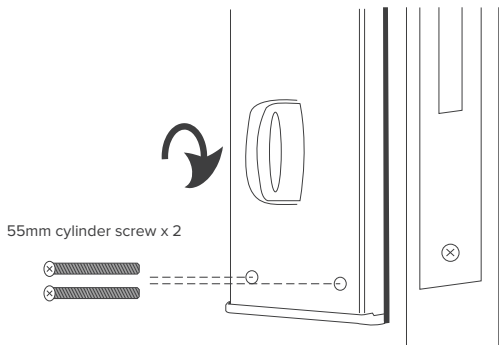

#### ■ Reverse thumbturn test

Close the front and rear panel. Rotate the rear panel thumbturn. Test whether the knob can pop up and recover the bolt. Then install a 55mm screw to secure the rear panel.

### Install the battery and back cover

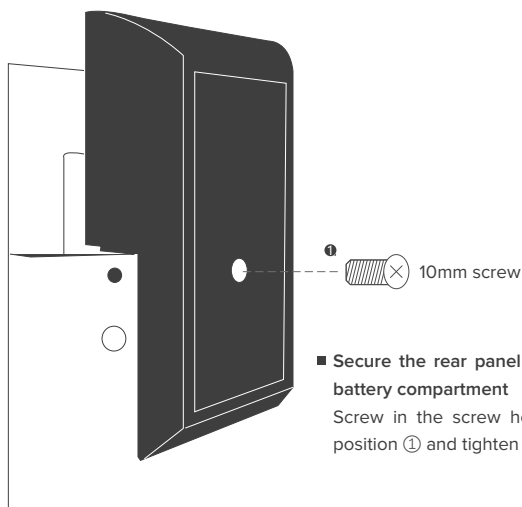

#### ■ Secure the rear panel and install the battery compartment

Screw in the screw hole. Installed in position ① and tighten the back cover.

### Front panel and function description

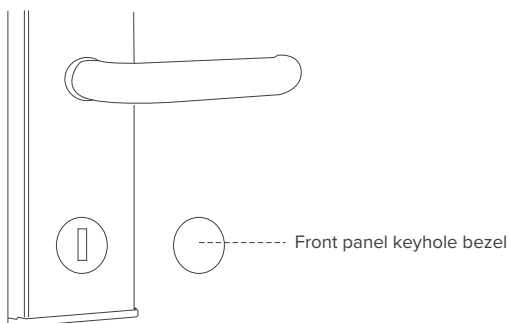

- If you cannot open the door due to lack of power for long periods of time without using the door lock, open the keyhole cover and open the door with a key.